



**Hornady**<sup>®</sup>  
*Accurate. Deadly. Dependable.*

INSTRUCTIONS

# VIBRATORY TRICKLER

Item No. 050102



Instructional videos for Hornady® reloading products are available at [hornady.com](http://hornady.com).

## POWER SUPPLY

Two (2) AAA batteries

## SETUP/ASSEMBLY

Make sure all parts are in good condition. Insert two AAA batteries, and test each setting by using the up and down arrows to ensure the motor runs correctly.

Settings include high, low and 1-10. The best setting will vary depending on the type of powder, the type of surface the device is sitting on and whether the Trickler body is in or outside the base.

## USING THE VIBRATORY TRICKLER

Place the Trickler on a flat surface. Set the powder pan and scale (not included) under the Trickler tube. Using a powder funnel (not included), pour the powder into the Trickler body until the body is filled above the trickle tube and within a half-inch of the upper rim of the Trickler body. Choose the desired setting, and begin use.

The Trickler can also be used outside the base. To remove it from the base, unwrap the power cord from the back of the Trickler body. Rotate the bottom of the motor mount counterclockwise. After the power cord clears the lip on the back of the base, lift the motor mount. Once the assembly is removed from the base, place it on a flat surface for use.

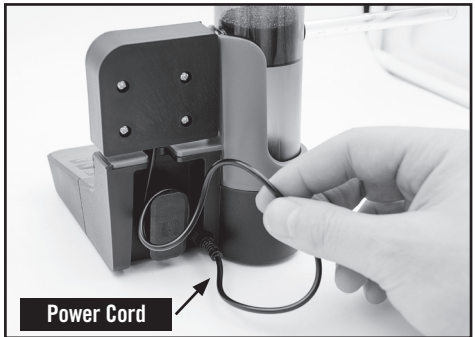
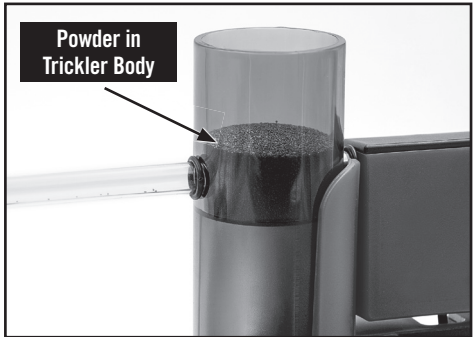

## EMPTYING POWDER FROM TRICKLER BODY

Powder can be emptied while the Trickler body is in or outside the base. To empty powder while the body is inside the base, tilt the assembly back and away from the trickle tube at a slight angle so the powder doesn't dump out of the tube. Place the funnel on the powder storage container and empty contents of the Trickler body slowly into the funnel. Then slowly pour the powder out of the Trickler tube and into the funnel. Repeat until all powder is removed from the Trickler.

To empty powder while the Trickler body is outside the base, tilt the body and tube assembly back and away from the tip of the tube at a slight angle so the powder doesn't dump out of the tube. Then continue procedure as normal.

## NOTE/WARNING

- Empty powder from the Trickler body after each use. Do not store powder in Trickler between reloading sessions.
- If the Trickler will not be used for an extended period of time, remove the batteries.
- If in doubt of what powder is in the Trickler, discard according to local regulations and get new powder.
- **NEVER** use with black powder – **for smokeless powder only.**

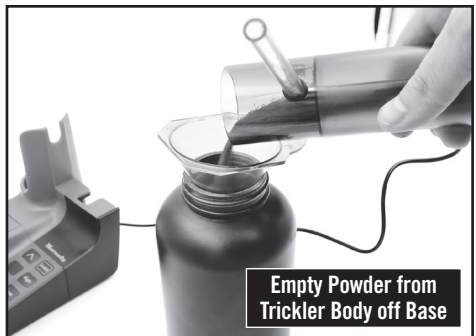
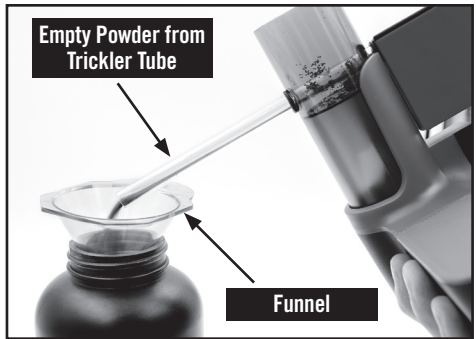
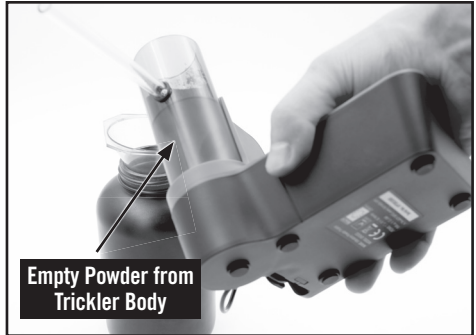
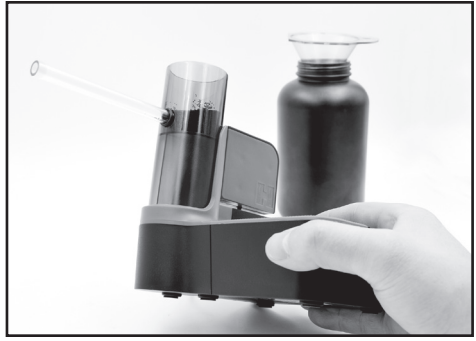

# WARRANTY

All Hornady® reloading tools and accessories are warranted against material defects and workmanship.

Hornady electronic components are covered by a one-year warranty from the date of purchase.

This warranty is void if the product (1) has been damaged by accident or unreasonable use, neglect, improper service or other causes not arising out of defects in material or workmanship; or (2) has been altered or repairs have been made or attempted by other than authorized factory personnel; (3) is used commercially; or (4) has been altered or defaced in any way.

This warranty supersedes all other warranties for Hornady® products either written or oral. No other warranty is expressed or implied.

## PRODUCT REGISTRATION AND SERVICE

You must register your product to obtain Warranty Service. Complete the registration form at [hornady.com/warranties](http://hornady.com/warranties).

## TO RECEIVE WARRANTY SERVICE

To report a warranty claim, call Hornady® at 800-338-3220 to request a return authorization number. Returns will not be accepted without prior return authorization by Hornady®.

## POST-WARRANTY SERVICE INFORMATION

For issues concerning service after the Limited Warranty expires, contact Hornady® at 800-338-3220.



## PRODUCT SERIAL NUMBER AND REFERENCE INFORMATION

You must register your product in order to obtain warranty service. In the event you should need service for your product, please note the following information:

**Serial Number** \_\_\_\_\_

**Date Purchased** \_\_\_\_\_

**Retailer** \_\_\_\_\_

### FCC STATEMENT

This equipment has been tested and found to comply with the limits for a Class B digital device, pursuant to part 15 of the FCC Rules. These limits are designed to provide reasonable protection against harmful interference in a residential installation. This equipment generates, uses and can radiate radio frequency energy and, if not installed and used in accordance with the instructions, may cause harmful interference to radio communications. However, there is no guarantee that interference will not occur in a particular installation. If this equipment does cause harmful interference to radio or television reception, which can be determined by turning the equipment off and on, the user is encouraged to try to correct the interference by one or more of the following measures:

- Reorient or relocate the receiving antenna.
- Increase the separation between the equipment and receiver.
- Connect the equipment into an outlet on a circuit different from that to which the receiver is connected.
- Consult the dealer or an experienced radio/TV technician for help.

**Hornady Manufacturing Company**

P.O. Box 1848, Grand Island, NE 68802-1848

[hornady.com/contact](http://hornady.com/contact)