

Universal Mounting Plate Instructions

The Hornady Universal Mounting Plate is designed for use with Hornady Tools. Hornady is not responsible for damage caused by using tools other than the recommended.

This mounting plate system is designed to allow fast and easy changeover from one reloading tool to another. Additional mounting plates are sold separately (Hornady Item #399698).

ITEM NO.	PART NUMBER	DESCRIPTION	QTY.
1	399687	Quick Disconnect Plate	1
2	399688	Quick Disconnect Foot Plate	2
3	399689	Extruded Mounting Rail	2
4	399690	Quick Detach Clamp	2
5	399360	SQUARE FINISHING PLUG 1"	4
6	392362	Carriage Bolt 3/8-16 x 2 1/2	8
7	380076	3/8 Hex Nut	8
8	392055	3/8 Flat Washer	8

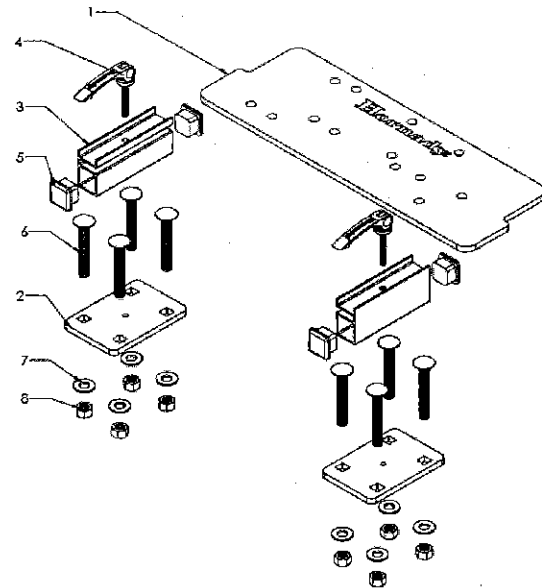

Setup:

Tools Needed:

- Pencil
- Power Drill
- 7/16" Drill Bit
- 9/16" Wrench
- Optional- Router and a 1/2" diameter straight bit

1. To begin, remove all parts and check that everything is present using the parts list above. Insert the 4 Finishing Plugs into the ends of the Mounting Rails.
2. Thread each QD Clamp through a Mounting Rail and into a QD Foot Plate as shown in
3. Clamp the two assemblies created in step 2 to the sides of the QD Plate as shown in. This may require some adjustment of the clamps. To achieve greater clamping force, thread the clamp into the Foot Plate further (clockwise). If the clamps are too tight and will not close completely, loosen them by threading them counterclockwise. A small gap between the QD Plate and the Mounting Rails is preferable.
4. The assembly will now be used to mark where to drill or route the bench top for installation of the Foot Plates. Position the Foot Plates as close to the front of the workbench as possible. Keep in mind the clearance required by the ram and toggle of any reloading presses you intend to use. If surface mounting, simply mark the bolt holes and drill using a 7/16" drill bit. If flush mounting is desired, mark the outside profile of the Foot Plate, and route .250" deep with a .5" diameter or smaller router bit.



Hornady

3625 W. Old Potash Hwy.
Grand Island, NE 68803
Office: 308-382-1390

5. With the benchtop drilled, bolt the Foot Plates down with the supplied 3/8" carriage bolts, washers, and nuts. The rounded head should be used on the top of the Foot Plates as shown in. Tighten securely.
6. Due to the large variation in tools that can potentially be mounted to this product, mounting bolts are not included. Mount your press or other tool by using bolts that are approximately 3/4" longer than the mounting flange of the tool you are mounting. For example, a Hornady Iron Press is approximately an inch thick at the mounting holes, so a 3/8-16x1.75" hex bolt would be appropriate. Tighten securely.

WARNING: Always be sure that the QD Plate is securely clamped in place and will not move before attaching or using the tools mounted to it. Tools falling off a workbench can cause serious injury.

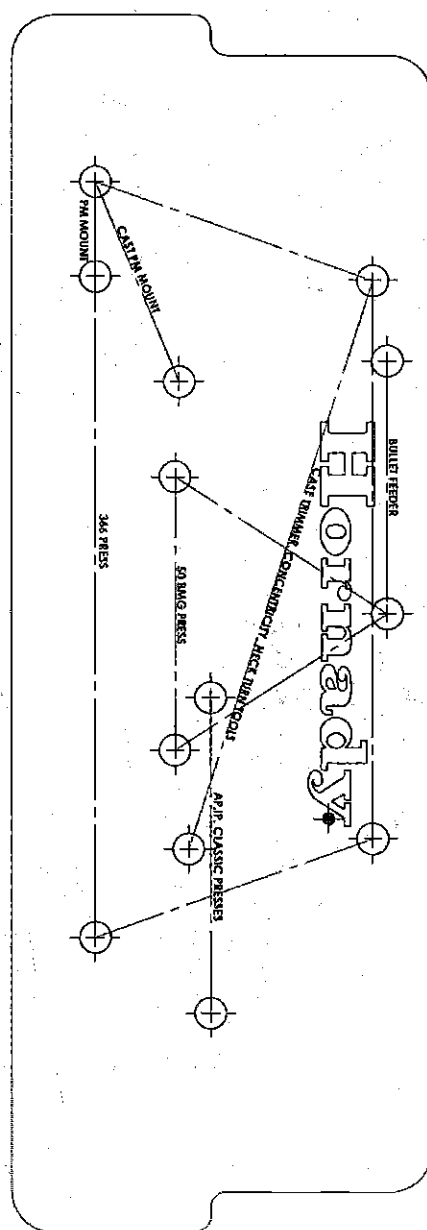

Hornady

3625 W. Old Potash Hwy.
Grand Island, NE 68803
Office: 308-382-1390