

Hornady
Accurate. Deadly. Dependable.

INSTRUCTIONS

Quick Detach Mounting System

Item No. 399697

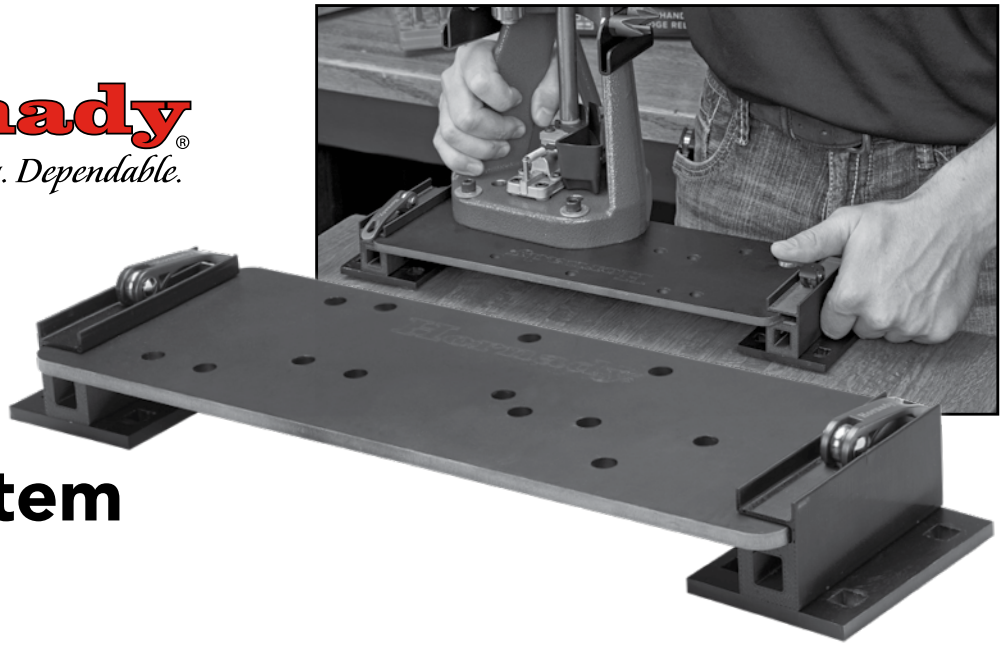

PARTS LIST

Item	Part No.	Description	Qty.
1	399687	Quick Detach Plate	1
2	399688	Quick Detach Foot Plate	2
3	399689	Extruded Mounting Rail	2
4	399690	Quick Detach Clamp	2
5	399360	Square Finishing Plug - 1"	4
6	392362	Carriage Bolt 3/8-16 x 2 1/2	8
7	380076	3/8 Hex Nut	8
8	392055	3/8 Flat Washer	8

Hornady Manufacturing Co.
P.O. Box 1848, Grand Island, NE 68802-1848
308-382-1390 • 800-338-3220 • Fax: 308-382-576
Hornady.com/contact

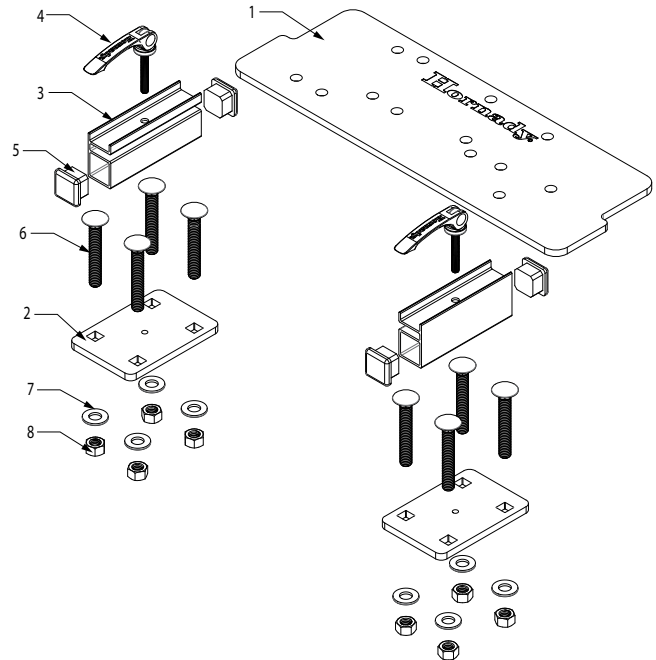

Mounting diagram for various Hornady Reloading Tools

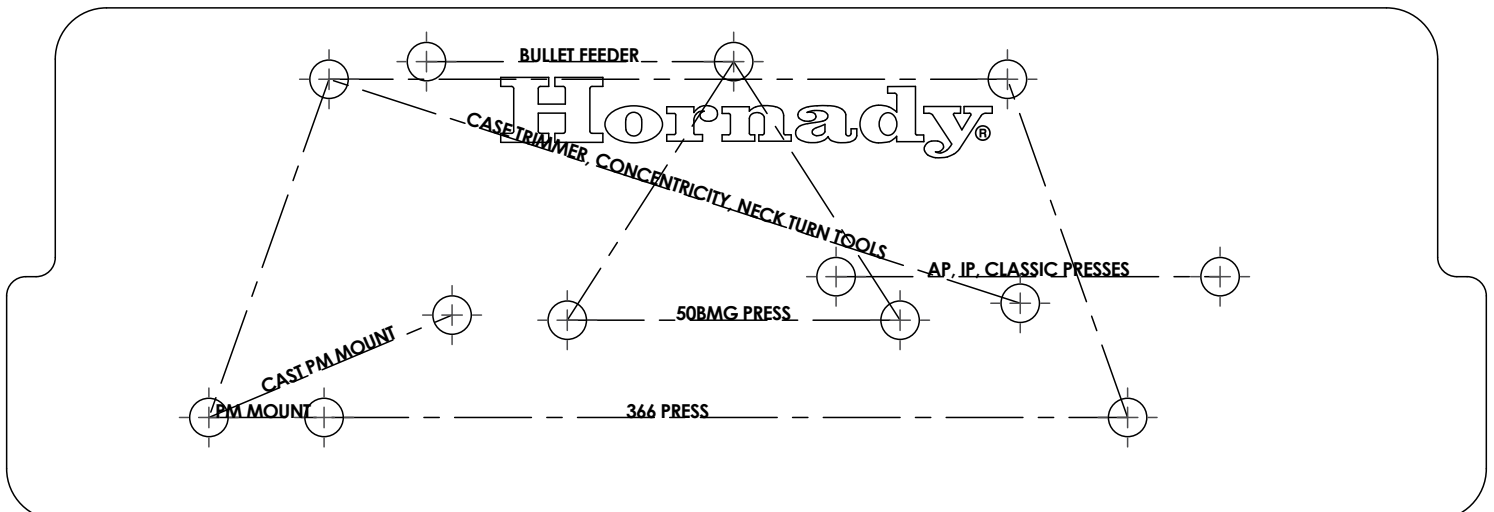

Quick Detach Mounting System Assembly Instructions

WARNING: Always be sure that the Quick Detach Plate is securely clamped in place and will not move before attaching or using the tools mounted to it. Tools falling off a workbench can cause serious injury.

This mounting plate system is designed to allow fast and easy changeover from one reloading tool to another. Additional mounting plates are sold separately (Item No. 399698). Other tools, such as vises or grinders, can also be mounted by marking and drilling the bolt hole locations on the detachable plate.

TOOLS NEEDED

- Pencil
- Power Drill
- 7/16" Drill Bit
- 9/16" Wrench
- Router and a 1/2" diameter straight bit (optional)

SETUP/ASSEMBLY

1. To begin, remove all parts and check that everything is present using the Parts List. Insert the four Finishing Plugs into the ends of the Mounting Rails.
2. Thread each Quick Detach Clamp through a Mounting Rail and into a Quick Detach Foot Plate (Fig. 1).
3. Clamp the two assemblies created in Step 2 to the sides of the Quick Detach Plate (Fig. 2). This may require some adjustment of the clamps. To achieve greater clamping force, thread the clamp further into the Foot Plate clockwise. If the clamps are too tight and will not close completely, loosen them by threading them counterclockwise. A small gap between the Quick Detach Plate and the Mounting Rails is preferable (Fig. 3).
4. The assembled Mounting System will now be used to mark where to drill or route the bench top for installation of the Foot Plates. Position the Foot Plates as close to the front of the workbench as possible (Fig. 4). Keep in mind the clearance required by the ram and toggle of any reloading presses you intend to use. If surface mounting, simply mark the bolt holes and drill using a 7/16" drill bit. If flush mounting is desired, mark the outside profile of the Foot Plate, and route a quarter-inch deep with a half-inch diameter or smaller router bit.
5. With the benchtop drilled, bolt the Foot Plates down with the supplied 3/8" carriage bolts, washers, and nuts. The rounded head should be used on the top of the Foot Plates (Fig. 5). Tighten securely.
6. Due to the large variation in tools that can be mounted to this product, mounting bolts are not included. Mount your press or other tools by using bolts that are approximately 3/4" longer than the mounting flange of the tool you are mounting. For example, a Hornady Iron Press is approximately an inch thick at the mounting holes, so a 3/8-16x1.75" hex bolt would be appropriate. Tighten securely.

