

## EXPLODED VIEW

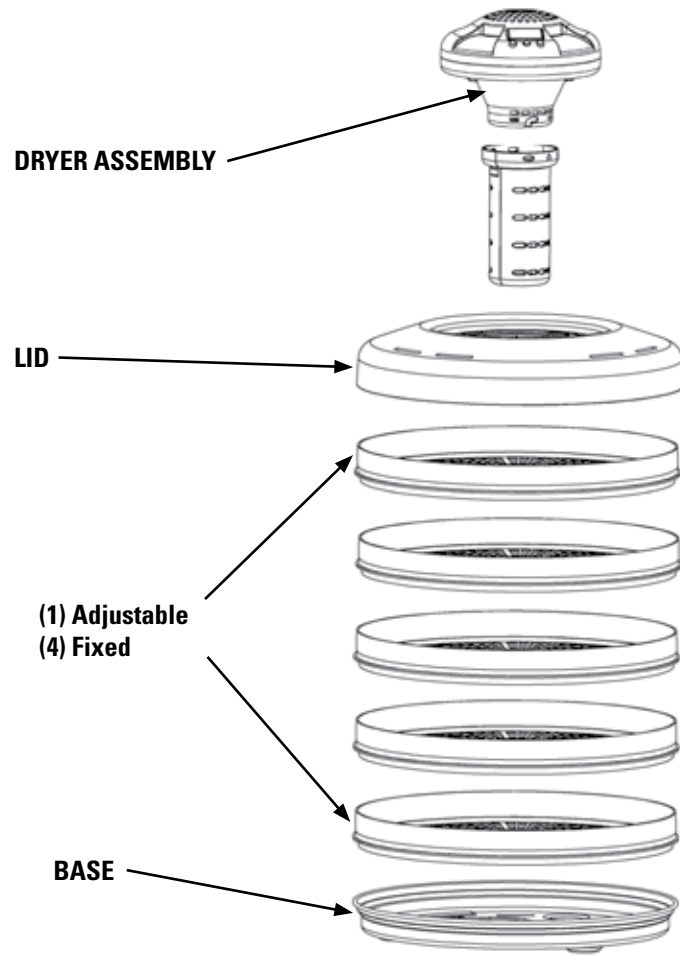

## SERVICE

Should you experience any problems other than routine cleaning, please call Customer Satisfaction at Hornady Manufacturing at 800-338-3220, or write us by visiting [Hornady.com/contact](http://Hornady.com/contact).

## SPECIFICATIONS

**Item Number:** 053311

**Dimensions:**

Total Height: 11.8"  
Diameter: 12.6"

Power: 110V AC (350W)  
Temperature Range: 104°F to 158°F

## WARRANTY

All Hornady® reloading tools and accessories are warranted against material defects and workmanship.

Hornady® electronic components are covered by a one-year warranty from the date of purchase.

This warranty is void if the product (1) has been damaged by accident or unreasonable use, neglect, improper service or other causes not arising out of defects in material or workmanship; or (2) has been altered or repairs have been made or attempted by other than authorized factory personnel; (3) is used commercially; or (4) has been altered or defaced in any way.

This warranty supersedes all other warranties for Hornady® products either written or oral. No other warranty is expressed or implied.

## PRODUCT REGISTRATION AND SERVICE

You must register your product to obtain Warranty Service. Complete the registration form at [hornady.com/warranties](http://hornady.com/warranties).

## TO RECEIVE WARRANTY SERVICE

To report a warranty claim, call Hornady® at 800-338-3220 to request a return authorization number. Returns will not be accepted without prior return authorization by Hornady®.

## POST-WARRANTY SERVICE INFORMATION

For issues concerning service after the Limited Warranty expires, contact Hornady® at 800-338-3220.

## PRODUCT SERIAL NUMBER AND REFERENCE INFORMATION

You must register your product in order to obtain warranty service. In the event you should need service for your product, please note the following information:

**Serial Number** \_\_\_\_\_

**Date Purchased** \_\_\_\_\_

**Retailer** \_\_\_\_\_



## INSTRUCTIONS

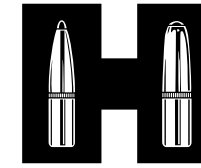

**Hornady**  
*Accurate. Deadly. Dependable.*

# DIGITAL CASES & PARTS DRYER



**Hornady Manufacturing Company**

P.O. Box 1848, Grand Island, NE 68802-1848

[hornady.com/contact](http://hornady.com/contact)

## IMPORTANT SAFEGUARDS

### This product is designed for household use.

When using electrical appliances, basic safety precautions should always be followed, including the following:

1. Read all instructions.
2. Do not touch hot surfaces.
3. To protect against electrical hazards, do not immerse blower or any part of the dryer cord or plug in water or other liquid.
4. Close supervision is necessary when any appliance is used by or near children.
5. Unplug from outlet when not in use and before cleaning. Allow the unit to cool before putting on and taking off parts.
6. Do not operate any appliance with a damaged cord or plug, or after the appliance malfunctions, or has been damaged in any manner.
7. The use of accessory attachments, not recommended by the appliance manufacturer, may cause hazards.
8. Sharp utensils should not be used inside the dryer.
9. Do not let cord hang over edge of table or counter, or touch hot surfaces.
10. Do not use outdoors.
11. Do not place on or near a hot gas or electrical burner, or in heated oven.
12. Do not use this appliance for other than its intended use.
13. Do not put live primers in dryer.

## SAVE THESE INSTRUCTIONS

**NOTE:** *This appliance has a polarized plug (one blade is wider than the other). As a safety feature, this plug will fit in a polarized outlet only one way. If the plug does not fit fully in the outlet, reverse the plug. If it still does not fit, contact a qualified electrician. Do not attempt to defeat this safety feature.*

**Short Cord Instructions** — a short power supply cord is provided to reduce the risk resulting from becoming entangled in or tripping over a longer cord.

Extension cords may be used if care is exercised in their use. If an extension cord is used, the marked electrical rating of the cord should be at least as great as the electrical rating of the appliance. The longer cord should be arranged so that it will not drape over the table top where it can be pulled on by children or tripped over unintentionally.

## DRYER USE AND CARE

**Caution:** *Do not put the blower in water or in the dishwasher.*

- Set the base tray on a sturdy countertop or table away from sinks or any source of water.
- Stack additional trays on the base tray. Your dryer requires a minimum of five trays to operate properly.
- Place the top cover on the top tray, insert the blower into the trays and rotate to lock in place
- Plug the cord into an electrical outlet, switch power to **ON** and you're ready to start drying cases and gun parts.

**Trays and Top Cover** — Your dryer trays and top lid are easy to clean. Simply soak the trays in warm water with a mild detergent for several minutes. Do not clean trays with any metal objects or scouring pads as they tend to damage the surface of the trays.

**Blower** — It is important that the air vents on the blower remain clean and unobstructed. **UNPLUG BLOWER BEFORE CLEANING.** Do not use scouring pads, abrasive cleaners or sharp utensils. Avoid dripping any liquid into electrical parts. Do not operate blower alone, or use in any capacity other than the intended use. **DO NOT OPERATE NEAR OR IMMERSE BLOWER IN WATER OR OTHER LIQUID.**

## TIME AND TEMPERATURE ADJUSTMENT

**Time** — The Hornady Digital Cases & Parts Dryer features an adjustable digital timer. The drying time can be adjusted from 15 minutes to 2 hours by pressing the **TIME** button.

**Temperature** — Most metal parts can be dried at the preset 158°F temperature. For sensitive items, start at the lowest temperature to prevent damage. To adjust the temperature setting, press the **TEMP** button to cycle through the 7 temperature settings.

**On/Off** — Press and release the **ON/OFF** button to turn the dryer on and off.

**NOTE:** *Unplug dryer when not in use.*

## DRYING TIME

Drying times may vary, depending on the type and amount of cases/gun parts, percentage of water, humidity, temperature of the air and the altitude. Drying times may also vary greatly from one area of the country to another and from day-to-day, depending on the climatic conditions. Record keeping helps you predict future drying times for specific cases and parts.

## TESTING FOR DRYNESS

Cases and parts must be monitored near the end of the drying process, making sure everything is properly dried. Do not load cases if they contain any moisture.

## ADJUSTABLE TRAY

The Adjustable Tray has a removable bottom mesh. Remove the bottom mesh to accommodate larger items by rotating clockwise until notch and tab align. Place sidewall ring on top of the four fixed trays to allow maximum clearance under the lid for larger items.

## RECORD KEEPING

Recording the following information can be helpful in improving your drying techniques and determining quantities of cartridge cases and types of gun parts to dry.

- Date dried.
- Quantity dried.
- Drying time.
- Storage temperature.
- Length of storage time before use.

By labeling storage containers with the contents and date dried, you can keep track of your supply, rotate as needed and avoid mix-ups.