



# RAPiD® VEHICLE SAFE

Mounting system conforms to vehicle shape without modification

Neoprene cover protects interior finishes

Keypad access with four- to six-digit security code

Pre-drilled holes for permanent mounting

14-gauge steel exterior housing

Secures duty-size or smaller handguns

1,500-pound security cable for attaching to seat frame

Touch-free entry with RFID wristband, key fob or decal

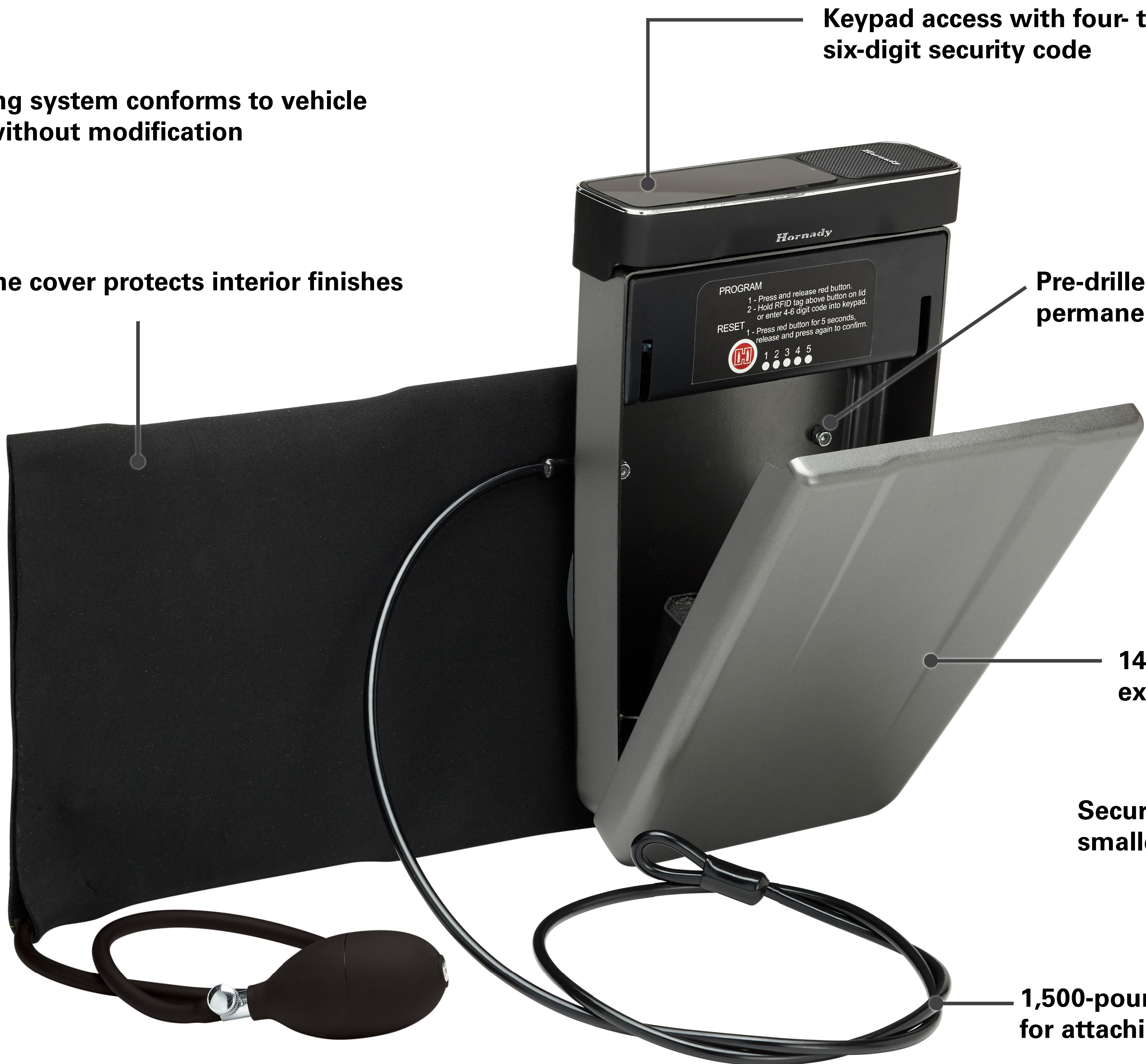





# RAPiD<sup>®</sup> VEHICLE SAFE

